

Objectif

- Réorganiser les équipes prêt-à-porter
- Établir de nouveaux organigrammes
- Calibrer et transformer les espaces pour faciliter la collaboration
- Limiter les travaux pour des raisons budgétaires et de perturbations des équipes pendant le développement des collections

Délai de conception

3 semaines sur site



Los Nuevos Artesanos
with XLc
Plaza de la Cruz Verde,
3, 3C
28005 MADRID, SPAIN
T. 645.605.409

CLIENT
COACH
516 West 34th Street
New York, NY 10001

PROJECT
COACH
Transformation
Program

PROJECT NO.
2013.04

ISSUE
01.25.15
DRAWN BY
Julien Pajot

Données
Générales

A.01



Schéma
Fonctionnel
Simplifié

A.03

ISSUE
01.25.15
DRAWN BY
Julien Pajot

PROJECT
COACH
Transformation
Program
PROJECT NO.
2013.04

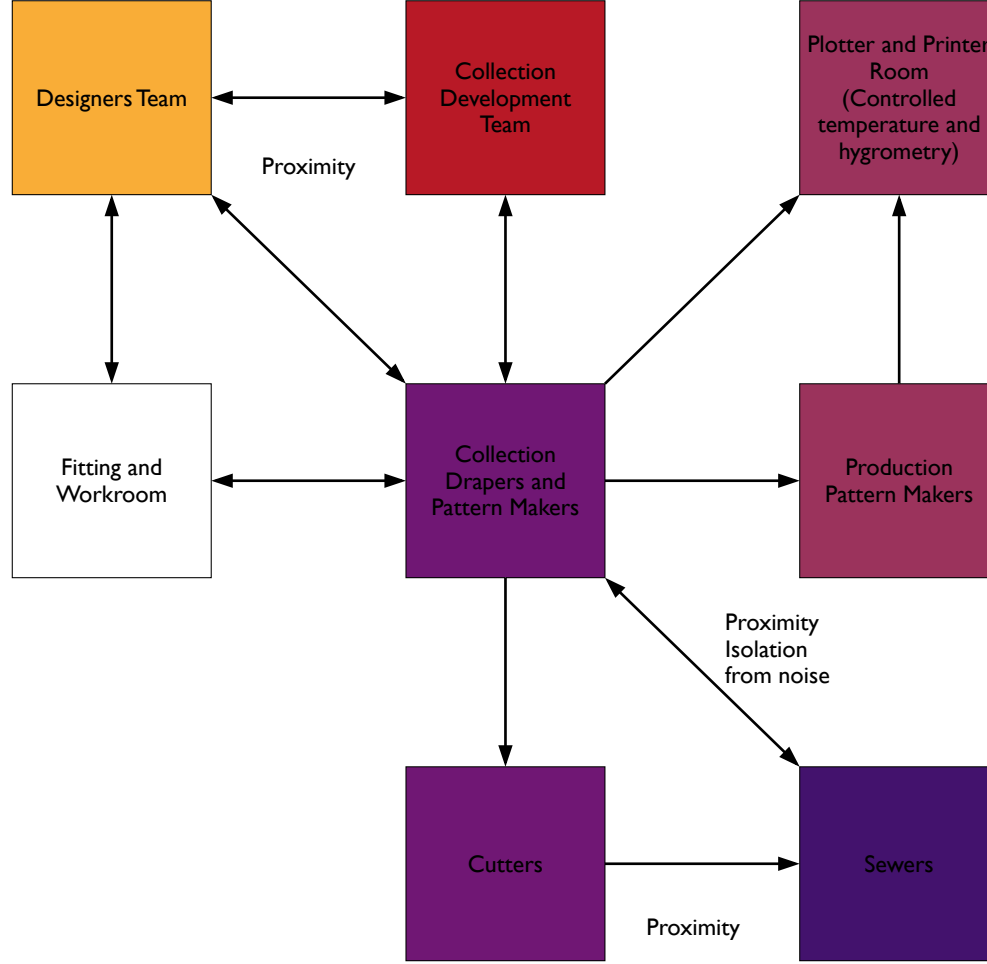
CLIENT
COACH
516 West 34th Street
New York, NY 10001

Los Nuevos Artesanos
with XLc
Plaza de la Cruz Verde,
3, 3C
28005 MADRID, SPAIN
T. 645.605.409



34th Street

Designers Team

Collection Development Team

Collection Drapers & Pattern Makers

Production Pattern Maker

Collection Sewers

Fitting Room



- + Équipes Prêt-à-porter homme au 3ème étage
- + Équipes de production/industrialisation au RDC
- + Plotter et traceur au RDC



Los Nuevos Artesanos
with XLc
Plaza de la Cruz Verde,
3, 3C
28005 MADRID, SPAIN
T. 645.605.409

CLIENT
COACH
516 West 34th Street
New York, NY 10001

PROJECT
COACH
Transformation
Program

PROJECT NO.
2013.04

ISSUE
01.25.15
DRAWN BY
Julien Pajot

516 W 34St.
R+I Avant

A.04

Designers Team

Collection Development Team

Collection Drapers & Pattern Makers

Production Pattern Maker

Collection Sewers

Fitting Room

34th Street

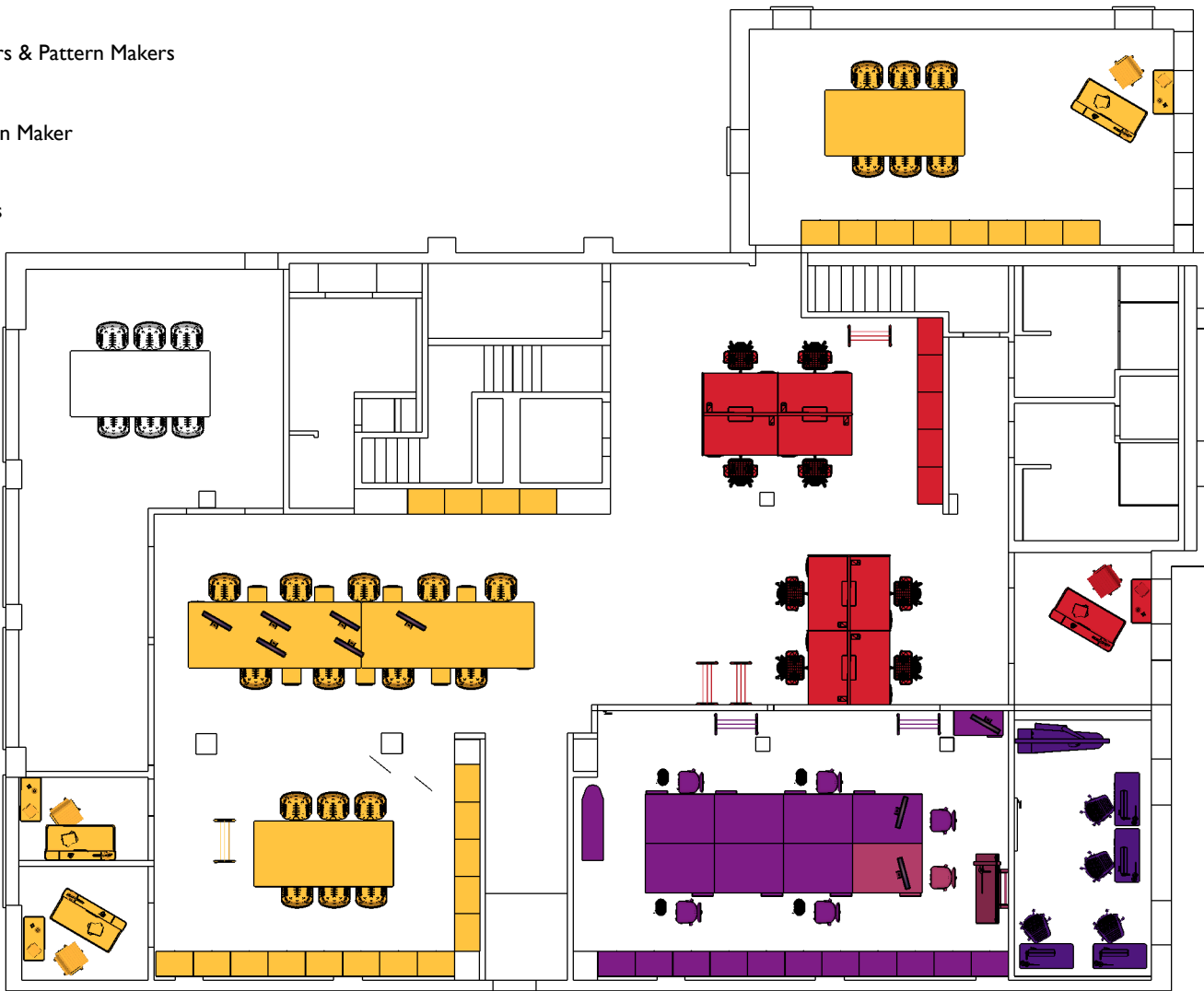



Designers Team

Collection Development Team

Collection Drapers & Pattern Makers

Production Pattern Maker

Collection Sewers

Fitting Room

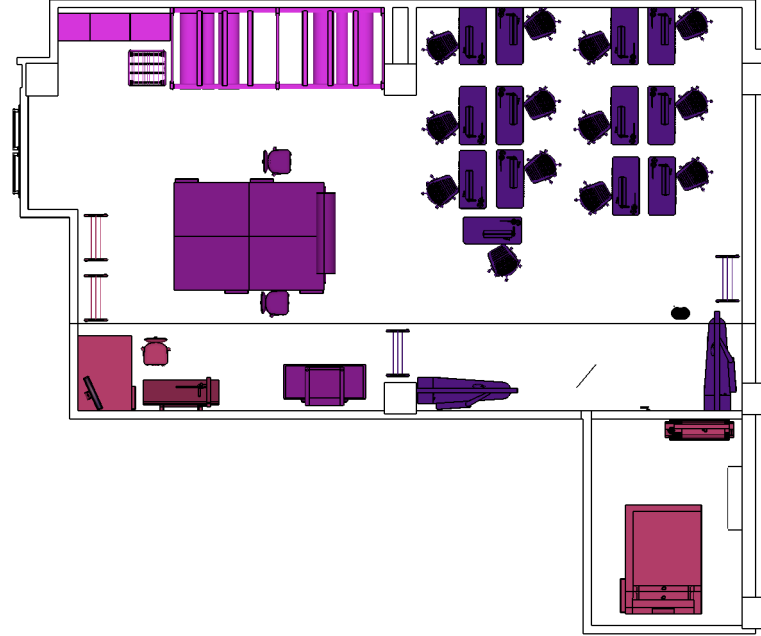

Prototypage et répétitions

Le R-1 est utilisé uniquement en fin de collection avant les défilés et sessions de ventes.

Cet espace reçoit les postes additionnels nécessaires à la fabrication des prototypes ou répétitions des produits vendus - il ne s'agit pas d'une production normalisée mais d'une mini chaîne de prototypage.

Un stock tampon de matières et fournitures est aussi aménagé

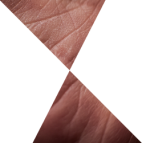

Los Nuevos Artesanos
with XLe
Plaza de la Cruz Verde,
3, 3C
28005 MADRID, SPAIN
T. 645.605.409

CLIENT
COACH
516 West 34th Street
New York, NY 10001

PROJECT
COACH
Transformation
Program

ISSUE
01.25.15
DRAWN BY
Julien Pajot

PROJECT NO.
2013.04

516 W 34St.
R-1

A.06

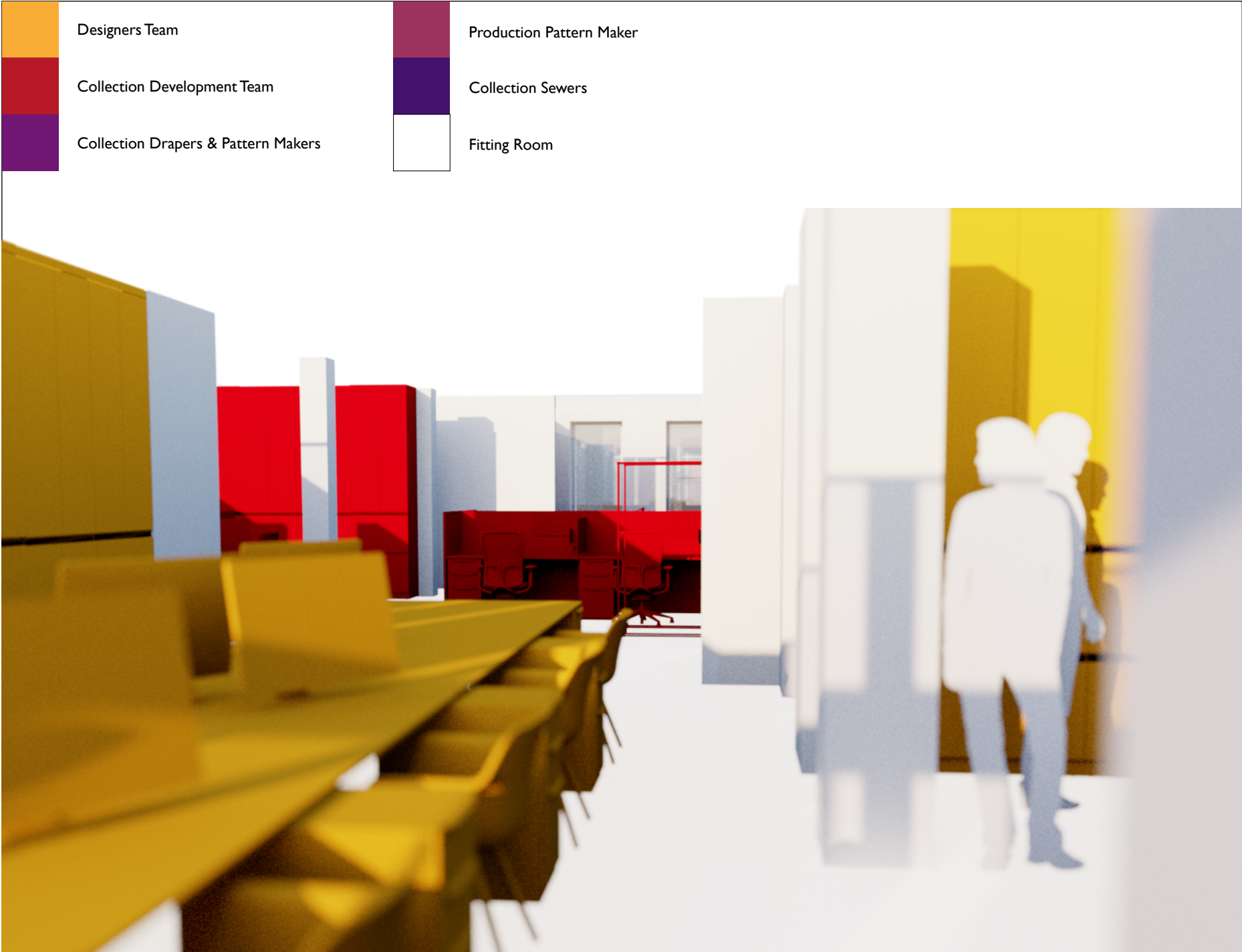

Designers Team

Collection Development Team

Collection Drapers & Pattern Makers

Production Pattern Maker

Collection Sewers

Fitting Room



Los Nuevos Artesanos
with XLc
Plaza de la Cruz Verde,
3, 3C
28005 MADRID, SPAIN
T. 645.605.409

CLIENT
COACH
516 West 34th Street
New York, NY 10001

PROJECT
COACH
Transformation
Program

ISSUE
01.25.15
DRAWN BY
Julien Pajot

PROJECT NO.
2013.04

Vues R+1

	Designers Team		Production Pattern Maker
	Collection Development Team		Collection Sewers
	Collection Drapers & Pattern Makers		Fitting Room

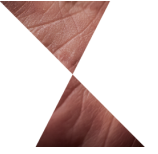
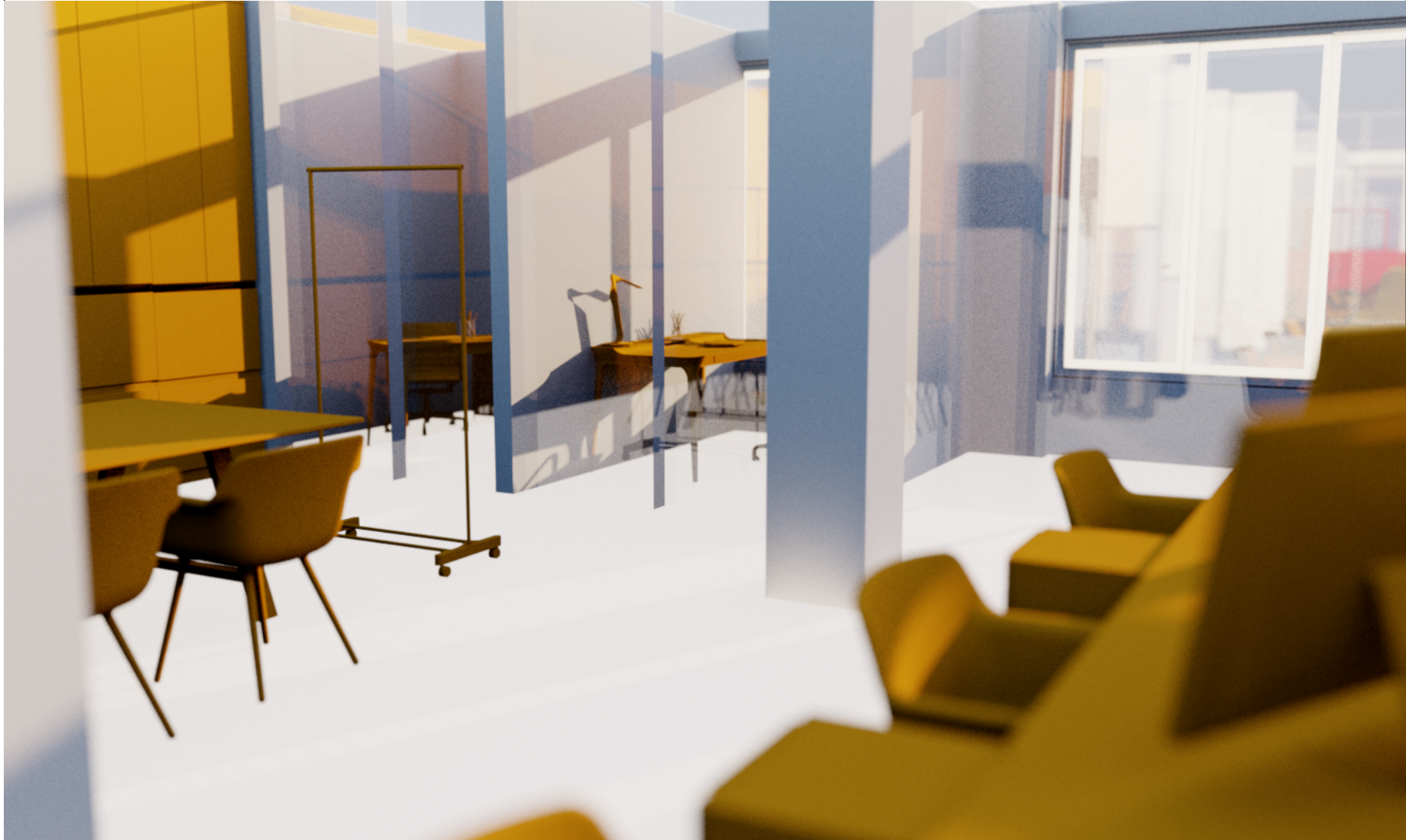

Los Nuevos Artesanos
with XLc
Plaza de la Cruz Verde,
3, 3C
28005 MADRID, SPAIN
T. 645.605.409

CLIENT
COACH
516 West 34th Street
New York, NY 10001

PROJECT
COACH
Transformation
Program
PROJECT NO.
2013.04

ISSUE
01.25.15
DRAWN BY
Julien Pajot

Vues R+1

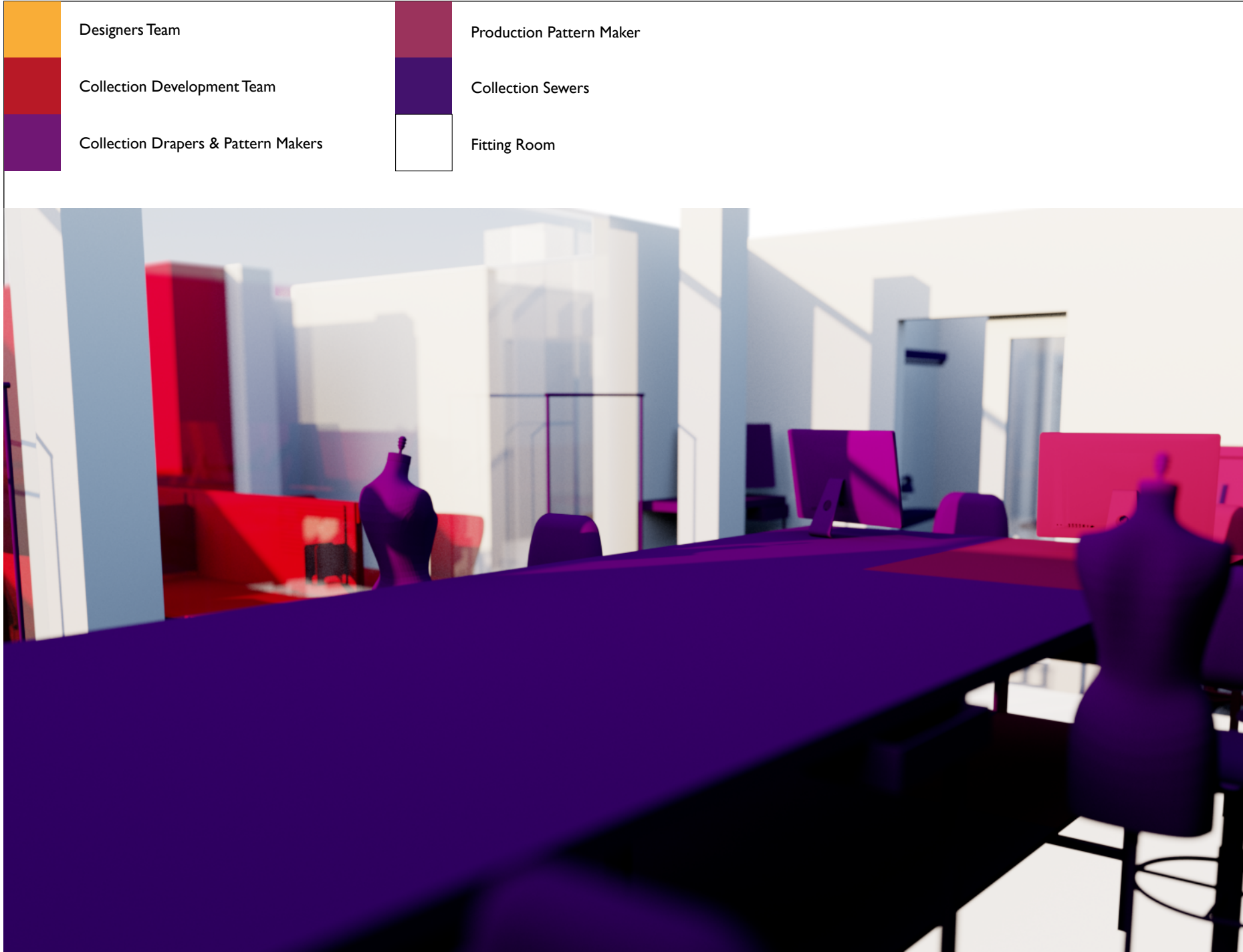

Designers Team

Collection Development Team

Collection Drapers & Pattern Makers



Production Pattern Maker

Collection Sewers

Fitting Room



Los Nuevos Artesanos
with XLc
Plaza de la Cruz Verde,
3, 3C
28005 MADRID, SPAIN
T. 645.605.409

CLIENT
COACH
516 West 34th Street
New York, NY 10001

PROJECT
COACH
Transformation
Program

PROJECT NO.
2013.04

ISSUE
01.25.15
DRAWN BY
Julien Pajot

Vues R+1

A.09

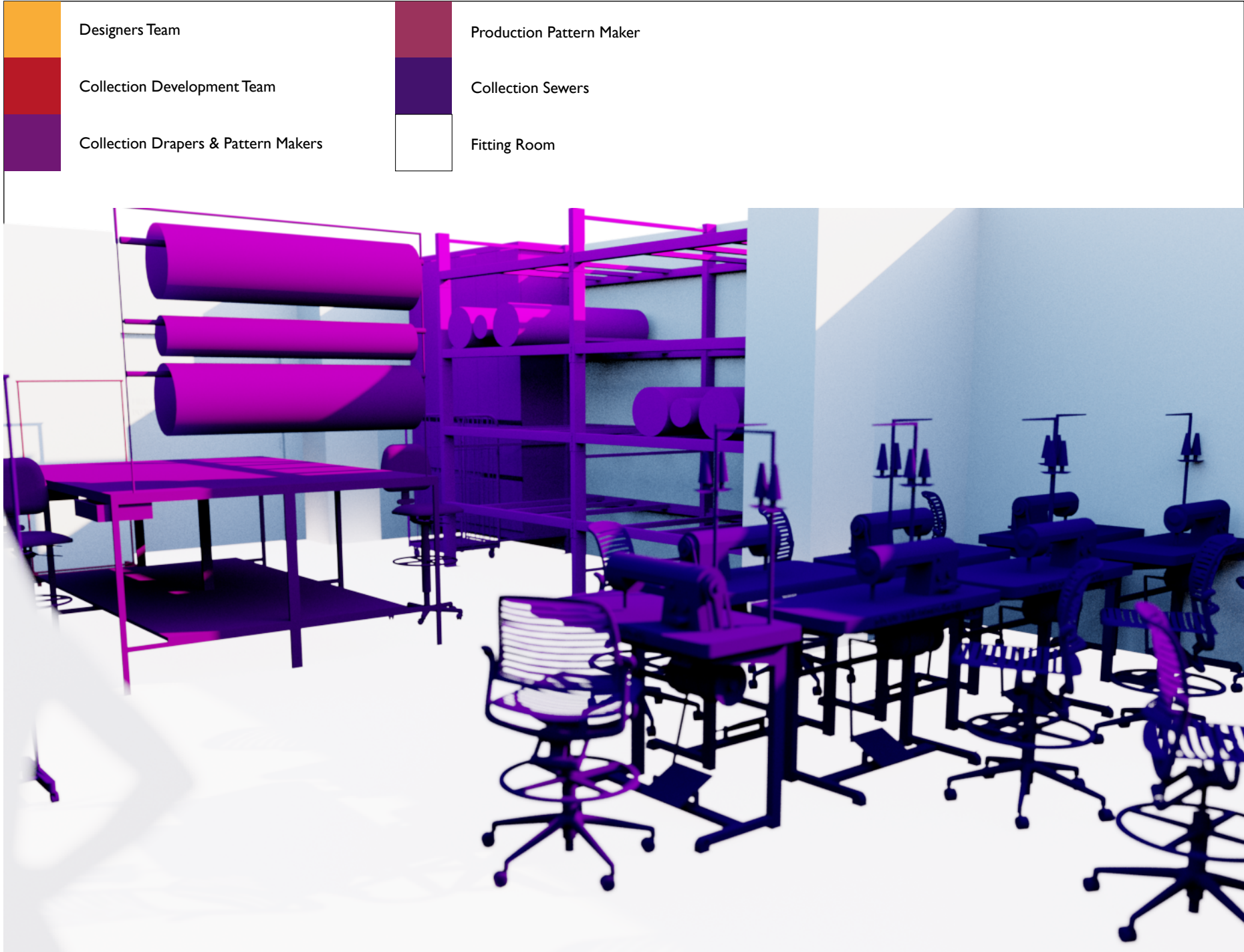

Designers Team

Collection Development Team

Collection Drapers & Pattern Makers

Production Pattern Maker

Collection Sewers

Fitting Room



Los Nuevos Artesanos
with XLc
Plaza de la Cruz Verde,
3, 3C
28005 MADRID, SPAIN
T. 645.605.409

CLIENT
COACH
516 West 34th Street
New York, NY 10001

PROJECT
COACH
Transformation
Program

ISSUE
01.25.15
DRAWN BY
Julien Pajot

PROJECT NO.
2013.04

Vues R-1

A.10